



Compact KWL® Heat recovery units KWL EC 200, 300 and 500

Hotline:
01206 228 500

Helios
HighVent®

NEW!



(KWL EC 200 & 300 Pro R)



(KWL EC 500 Pro R)



SPECIFICATION

- Heat exchanger**
 High efficiency cross counter flow heat exchanger manufactured in aluminium.
- Electrical connection**
 All models are fitted with electric cable for connection with a 3 pin plug.
- Heater**
 Pro models have an electric pre-heater as standard.
- Fans**
 Two silent centrifugal fans with efficient EC motors.
- Filters**
 Fitted with G4 filters as standard, F7 filters are optional. Type 300 Pro has F7 as standard on intake.
- Installation**
 Installation on the wall with the duct connections on the top.
- Heat exchanger**
 LON, 0–10 V or 4–20 mA, humidity and CO automatic control.
- Casing**
 Double skinned insulated panels of painted galvanised steel. Easy access via removable front panel.
- Controllers – Eco & Pro**
 Eco – speed controller 3 speed switch.
 Pro – controller has 8 speeds for automatic control and with accessories of BMS control (EIB,

KWL EC 200.. R & 300.. R

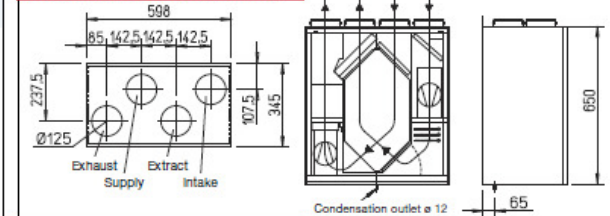

KWL EC 500.. R

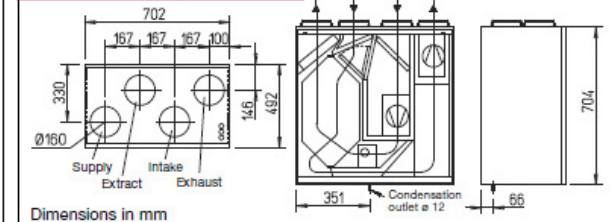

ANCILLARIES

Fan code	Silencer (SRSD) dia/length	Enthalpie heat exchanger	Clock timer	Additional controller	CO ₂ sensor	Humidity sensor	EIB-BMS-module	LON-BMS-module	Spare filter pack 2 pcs. G4 or 2 pcs. G4 + 1 pc. F7*	Spare filter pack 1 pc. F7
KWL EC 200 Eco R	SRSD 125/600	KWL-ET 200	WSUP	–	–	–	–	–	ELF-KWL 200/4/4	ELF-KWL 200/7
KWL EC 200 Pro R	SRSD 125/600	KWL-ET 200	–	KWL-FB	KWL-KDF	KWL-FF	KWL-EB	KWL-LB	ELF-KWL 200/4/4	ELF-KWL 200/7
KWL EC 300 Eco R	SRSD 125/600	KWL-ET 300	WSUP	–	–	–	–	–	ELF-KWL 300/4/4	ELF-KWL 300/7
KWL EC 300 Pro R	SRSD 125/600	KWL-ET 300	–	KWL-FB	KWL-KDF	KWL-FF	KWL-EB	KWL-LB	ELF-KWL 300/4/4/7*	–
KWL EC 500 Eco R	SRSD 160/600	KWL-ET 500	WSUP	–	–	–	–	–	ELF-KWL 500/4/4	ELF-KWL 500/7
KWL EC 500 Pro R	SRSD 160/600	KWL-ET 500	–	KWL-FB	KWL-KDF	KWL-FF	KWL-EB	KWL-LB	ELF-KWL 500/4/4	ELF-KWL 500/7

Single phase models 230 V / 1 ph. / 50 Hz

SELECTION DATA

Fan code	Max. volume flow at operation level	Volume flow at highest level l/s against pressure Pa								Motor power*	Nominal power max.	Summer bypass	Temperature range	Weight	Sound level @ 4 m intake*
		l/s	50	100	150	200	250	300	350						
KWL EC 200 Eco R	22 / 36 / 56 / 65 / 79	71	63	51	38	22	6			7 / 11 / 21 / 31 / 49	0.7	manually	-20 to +40	40.0	8 – 24
KWL EC 200 Pro R	15 / 22 / 29 / 36 / 44 / 56 / 65 / 79	71	63	51	38	22	6			5 / 7 / 9 / 11 / 16 / 21 / 31 / 49	5.1	autom.	-20 to +40	41.0	7 – 24
KWL EC 300 Eco R	46 / 67 / 85 / 93 / 100	94	90	85	78	71	64	57	47	18 / 36 / 65 / 80 / 97	1.3	manually	-20 to +40	41.0	15 – 29
KWL EC 300 Pro R	29 / 46 / 54 / 67 / 75 / 85 / 93 / 100	94	90	85	78	71	64	57	47	10 / 18 / 25 / 36 / 46 / 65 / 80 / 97	5.7	autom.	-20 to +40	42.0	12 – 29
KWL EC 500 Eco R	53 / 76 / 101 / 119 / 153	146	139	132	124	114	100	86	69	16 / 30 / 50 / 79 / 143	1.8	manually	-20 to +40	65.0	15 – 36
KWL EC 500 Pro R	53 / 65 / 76 / 89 / 101 / 119 / 138 / 153	146	139	132	124	114	100	86	69	16 / 22 / 30 / 42 / 50 / 79 / 110 / 143	6.2	autom.	-20 to +40	66.0	15 – 36

* Values referring to operation levels.